

US A600 Show and Sell



MAKE IT
Wonderful!

FRANKE

Basic Layout



SU05
Refrigerator

A600

Flavor
Station

Cup
Warmer

Finer Points

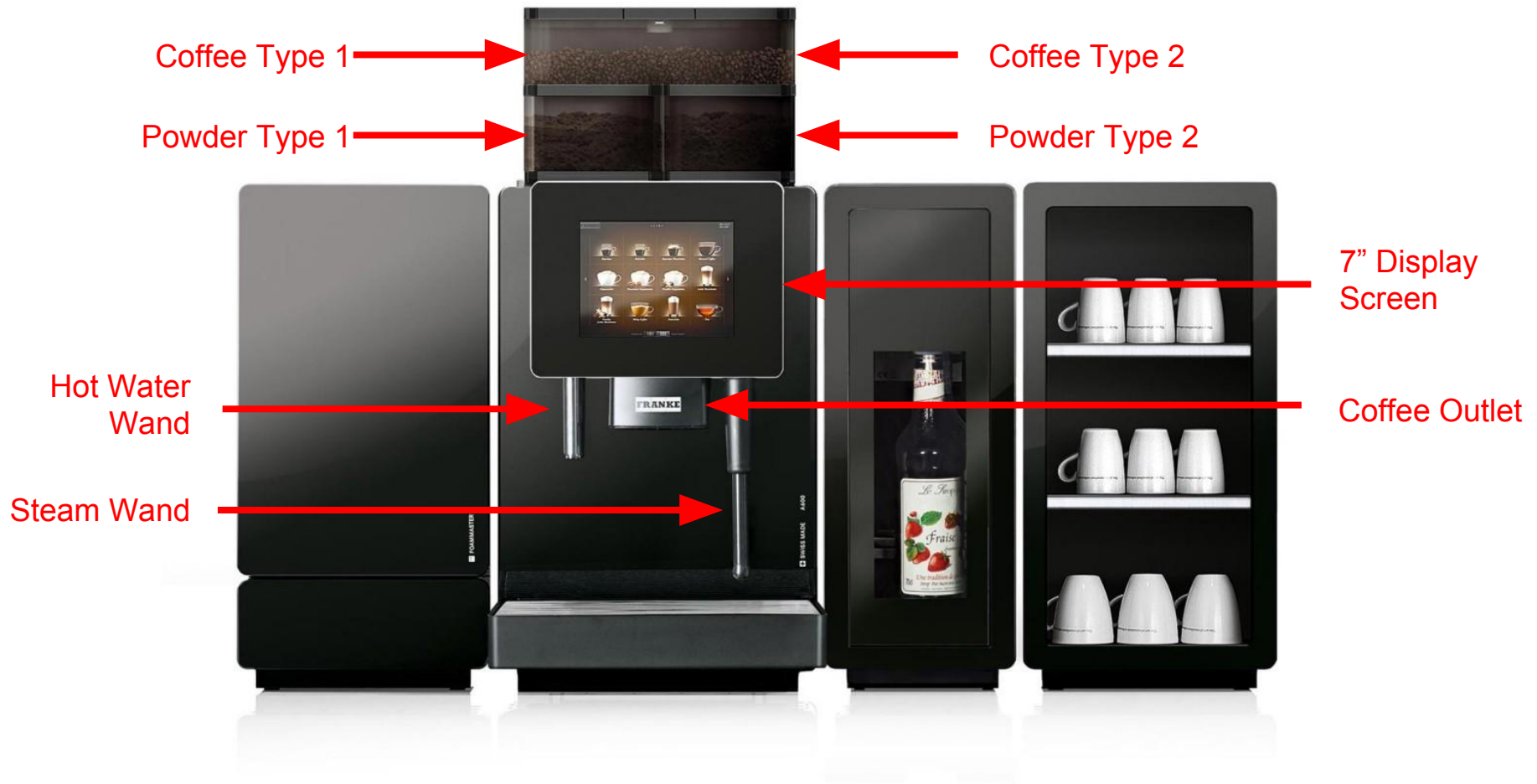

Capacities



Power Specifications



- 110 V
- 15 Amp Breaker

- 200-240V
- 30 Amp Breaker
- Single Phase

- 110 V
- 15 Amp Breaker

- 110 V
- 15 Amp Breaker

Power Specifications



Water Specification

Characteristic	Target	Acceptable Range
Odor	Clean / Fresh, Odor Free	
Color	Clear Color	
Temperature	40 F < Temp < 100 F	
Total Chlorine	0 mg/L	
Free Chlorine	<.05 mg/L	
Total Chlorides	<30 mg/L	
TDS	150 mg/L	75 - 250 mg/L
Calcium Hardness	4 gpg or 68 mg/L	1-5 gpg or 17-85 mg/L
Total Alkalinity	40 mg/L	39-41 mg/L
pH	7.0	6.5-7.5
Sodium	10 mg/L	9-11 mg/L
Silica	<5 mg/L	
Sulfate	25-50 mg/L	
Total Iron	0 mg/L	
Hydrogen Sulfide	0 mg/L	
Manganese	0 mg/L	
Nitrate	0 mg/L	
Water Pressure	80 to 800kPa (0.8 to 8.0bar)	

* Defined in separate specification sheet available for download

Hopper Configurations

Hopper Configuration 1

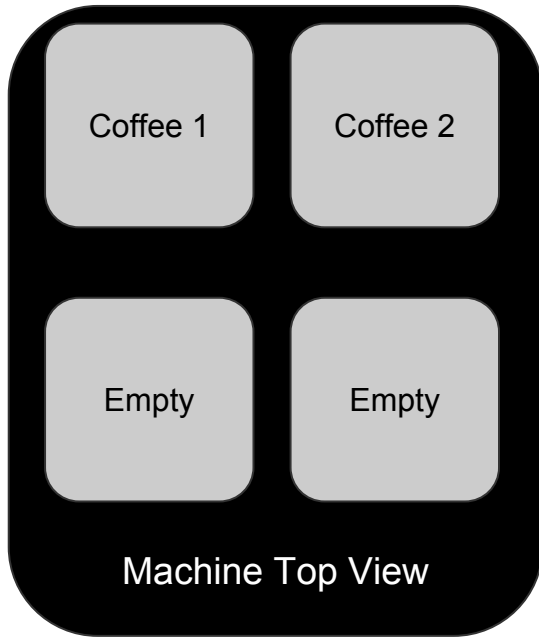

Hopper Configuration 2

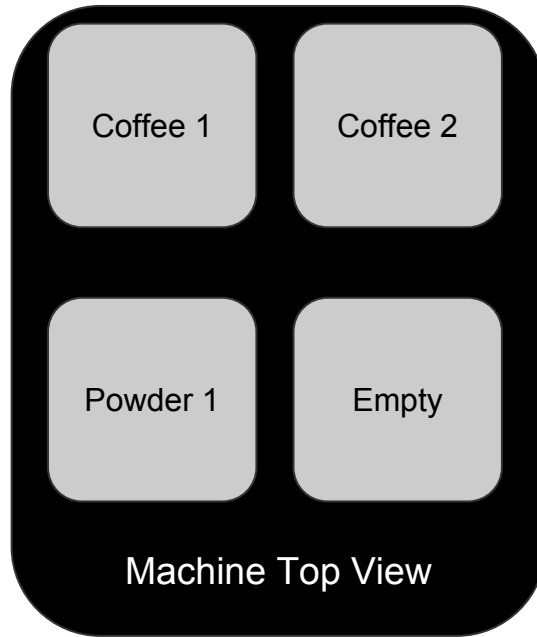

Hopper Configuration 3

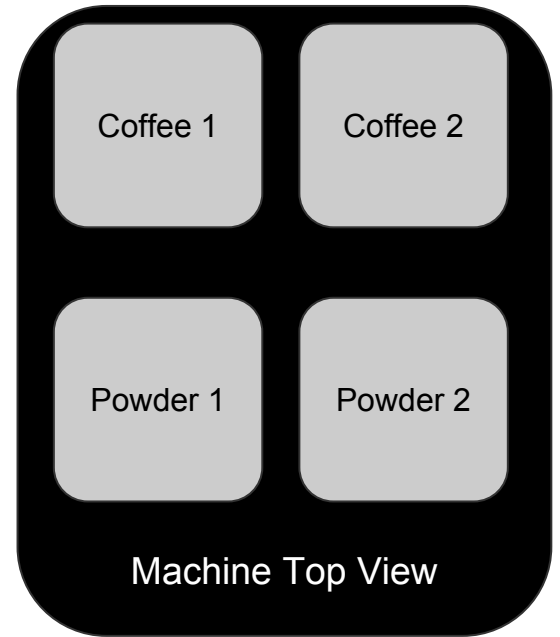

Milk System (MS2) Refrigeration Options



KE200 Refrigerator with Rinse Adaptor

- Refrigeration unit with front key lock, holds 1 US gallon



REFRIGERATION UNIT SU05 (5 l)

- Refrigeration unit with top left key lock, holds 1 US gallon

Rinse Adapter Feature

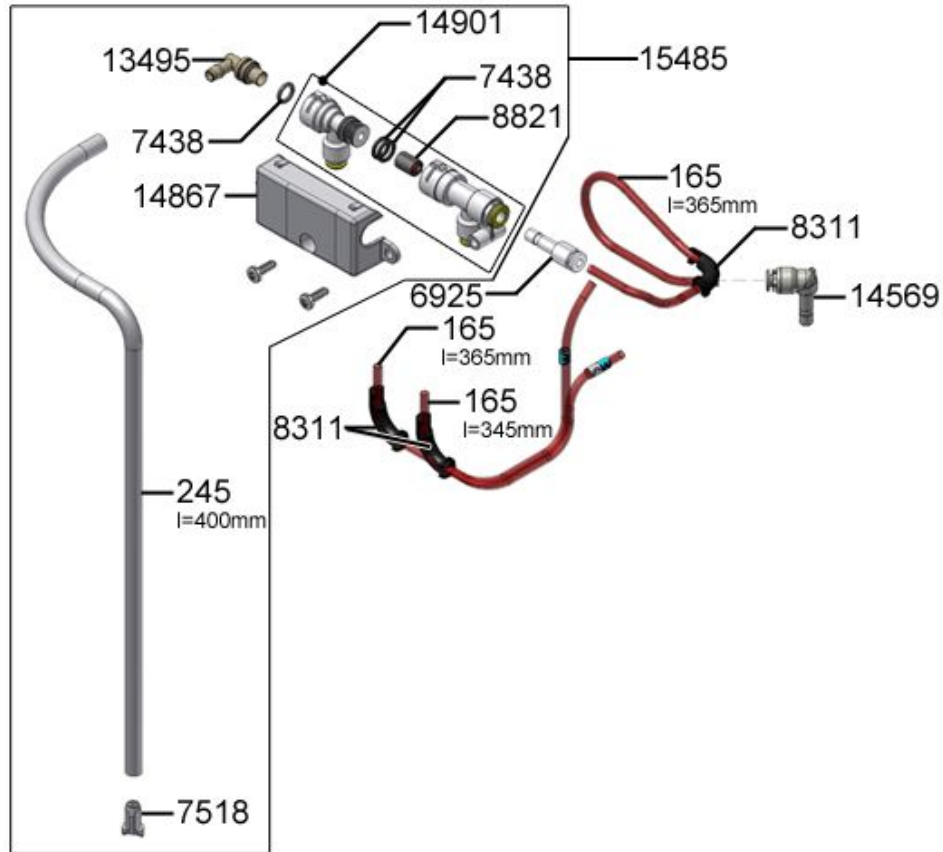

- This feature is only used for the milk system
- Can be retrofitted when necessary
- Comes standard on new MS2 Systems
- Separate Kit Part Number: 1Z365485

FoamMaster (FM1) Refrigeration Options



REFRIGERATION UNIT SU05 (5 l)

- 1 Milk type
- Refrigeration unit with top left key lock, holds 1 gallon



REFRIGERATION UNIT SU12 (12 Liters)

- 1 Milk type
- Refrigeration unit with top left key lock, holds 2 gallons
- Coming Soon (by May 2017)

Autosteam Technology

Features

- Manual heating and frothing of milk using steaming pitcher
- Automatic Temperature Control
- High Turbulence Wand Tip design
- Hand Guard for easy maneuvering of wand while hot
- Easy-to-clean plastic components

Use Cases:

- Alternate milk type scenarios (soy, almond milk, etc.) when installed on 1 step

Where to Find:

- Can be placed on MS2 and FM1 milk systems



Flavor Station Add On Unit



Features

- Dosing station with three flavors
- Any bottle can be used if it fits in the drawer
- Automatic dosing of flavor per drink per size
- Door lock for secure storage

Payment Add On Units



Token
System

Token System

- Available Now
- PN: 70008911 (System Only)
- PN: K557836 (System + 250 Tokens)

Card Swipe System

- Requires separate contract and fees with payment company
- Coming Soon (by May 2017)

Side Unit Part Numbers



SU05
Refrigerator
PN: 70008763

Flavor
Station
PN: 70008858

Cup
Warmer
PN: Coming
Soon

Side Unit Part Numbers



MS2 KE200
Refrigerator
PN: 70004379



MS2 SU05
Refrigerator
PN: 70008764

Available Machine Part Numbers

Part Reference		Side Unit Compatibility					Grinders		Powder		Wands		Locks
Part Number	Model #	FM SU05 (compatible)	Milk System KE200 (compatible)	Milk System SU05 (compatible)	Flavor Station (compatible)	Milk Types	1st Grinder	2nd Grinder	1st Powder	2nd Powder	Hot Water	Auto Steam	Self Service
70008931	A600 FM1 1G 1P H1	yes	-	-	yes	1	yes	-	yes	-	yes	-	-
70008762	A600 FM1 2G 1P H1	yes	-	-	yes	1	yes	yes	yes	-	yes	-	-
70008985	A600 FM1 2G 2P H1 SS	yes	-	-	yes	1	yes	yes	yes	yes	yes	-	yes
70009024	A600 FM1 2G 1P H1 SS	yes	-	-	yes	1	yes	yes	yes	-	yes	-	yes
70009013	A600 FM1 2G 2P H1 S2	yes	-	-	yes	1	yes	yes	yes	yes	yes	AS	-
70008989	A600 MS2 2G 1P H1	-	yes	yes	-	1	yes	yes	yes	-	yes	-	-
70009048	A600 MS2 1G 1P H1	-	yes	yes	-	1	yes	-	yes	-	yes	-	-
70009047	A600 MS2 2G 1P H1 S2	-	yes	yes	-	1	yes	yes	yes	-	-	AS	-
70009061	A600 MS2 2G 2P H1	-	yes	yes	-	1	yes	yes	yes	yes	yes	-	-

Key	Description
A600	A-Line 600 Series Platform
FM1	Foam Master (Single Milk) SU05 Compatible
MS2	Milk System (Single Milk) KE200/SU05 Compatible
1G	1 Grinder
2G	2 Grinders
1P	1 Powder Type
2P	2 Powder Types
H1	Hot Water Wand
SS	Self Service
S2	Auto Steam Wand
S3	Auto Steam Pro Wand

Color Options



Black Panels for Foam Master configurations



Gray Panels for Milk System configurations

Water Filter and Install Kit Part Information

Install Kit

- Part Number: 1558572-1
- Includes:
 - (1) 1556897 - Water Test Strip
 - (1) 1557801 - Customer Support Sticker
 - (1) 1556908 - Hose Fitting 3/8 Comp x 3/8 BSP
 - (1) 1556911 - 48" Steel Braided Hose
 - (1) 1557806 - MSDS for Cleaning Tablets
 - (1) 1557807 - MSDS for Milk Cleaner

Water Filter Kit - Mavea Purity C300 Quell ST

- Part Number: 1557784
- Includes:
 - (1) 1556480 - Filter Cartridge f/ Brita / Mavea Purity c300
 - (1) 1556481 - Head f/ Brita / Mavea Purity c300
 - (1) 1556482 - Mavea Water Test Kit
 - (1) 1556911 - 48" Steel Braided Hose
 - (1) 1553629 - Seal $\frac{3}{8}$
 - (1) 1550985 - 3/8 Fitting

Periodic Maintenance Pricing

A600 MS2 Maintenance Visits

- 40k Cycles Visit = \$950
- 80k Cycles Visit = \$1,600
- 120k Cycles Visit = \$950
- 160k Cycles Visit = \$2600

A600 FM1 Maintenance Visits

- 40k Cycles Visit = \$1350
- 80k Cycles Visit = \$2300
- 120k Cycles Visit = \$1350
- 160k Cycles Visit = \$3200

Powder System

- 40k Cycles Visit = Additional \$100
- 80k Cycles Visit = Additional \$270
- 120k Cycles Visit = Additional \$100
- 160k Cycles Visit = Additional \$550

Flavor Station

- 40k Cycles Visit = Additional \$100
- 80k Cycles Visit = Additional \$550
- 120k Cycles Visit = Additional \$100
- 160k Cycles Visit = Additional \$520

* Simplified PM cost charts, based on cycles, available upon request.

** No PM included in machine sale price

FAQs

What are the differences between an A600 FM and A600 Milk System?

Answer: The A600 FM can produce cold foam and has clean-in-place technology. FoamMaster technology can also produce precise variable foam (from soupy latte foam to dry cappuccino foam) on demand per drink.

How many drinks can I serve per day with the A600?

Answer: The A600 is a great option to produce up to 150 cups per day.

How many and which milk types can I use with the A600?

Answer: Franke recommends dairy milk for the A600 1-step, and the unit can accommodate one milk type (skim, 1%, 2% or whole). If a customer wants to incorporate non-dairy types of milk (soy, almond, etc.), we recommend using the Autosteam wand and not a 1-step configuration.

FAQs (continued)

How much coffee can I dose in the A600 brew chamber?

Answer: 22 grams maximum.

How many different drinks can I program into the A600?

Answer: The A600 FM can produce a myriad of espresso-based beverages using variable milk foam, cold foam, steamed milk, powders (2) and syrups (3). The maximum number of drinks is 100, with 20 per screen. But most menus use between 12 and 16 drinks with options during selection (i.e. flavor / size / extra shot).

What is cold foam, and can I produce it with the A600?

Answer: Cold foam is a cold velvety milk that is aerated to perfection. It can be used with iced lattes, iced cappuccinos and other such beverages. The temperature of the cold foam helps maintain the integrity of the ice and overall beverage.

FAQs (continued)

Can the A600 be set up as a self-serve unit?

Answer: The A600 FM or Milk System 1-step units can be set-up for both self-serve or barista led programs. The photo-realistic icons of the touchscreen display encourage user interaction, and its simple and clear user interface offers a versatile experience regardless of where the equipment is placed.

What is the A600 warranty?

Answer: The A600 comes with a standard 12 months parts and labor warranty. Additional warranty can be purchased.

How does Franke support the A600 for after sales technical needs?

Answer: Franke boasts a 24/7/365 customer service support line and a certified third party service network. Standard service hours are 8 AM to 5 PM in your local time zone, with overtime and weekend support available as necessary.

FAQs (continued)

How often must the A600 be cleaned?

Answer: The A600 daily cleaning is an 18 minute overall process. The A600 MS2 utilizes EasyClean process, and the A600 FM1 utilizes the CleanMaster technology.

What is Clean Master?

Answer: Clean-in-place technology auto supplies cleaner from installed cartridge in refrigerator, eliminating the need for the customer to dose the cleaner manually

Note: Found in A600 FM1 Models

What is Easy Clean?

Answer: Automated feed of wash / rinse / sanitize water into the cleaning container. User must manually dispense the cleaning solution into the container as instructed on the screen, but the machine does the rest.

Note: Found in A600 MS2 Models

FAQs (continued)

Does Franke Offer the A600 as a 2 Step configuration?

Answer: At this time, the boiler capacity of the A600 is not sufficient in a purely steam wand operated cafe setting. The steam wand can be used as an add on for 1 step configurations in order to steam alternate milk types.

Resources Available From Product Development

- Service Spare Parts Lists
- PM Parts Kits
- PM Instruction Documents
- User Part List (BU / Outlet / Powder / Hopper)
- User Level Troubleshooting and How To Documents
- Recommended Configuration File
- Standard Recipes and Recommended Settings
- Online Training and Recertification
- Install Checklist
- 3 Month Visit Checklist
- Online Site Readiness Form
- Small / Large Account Implementation Standard Procedures
- Standard Repair Times

* Coming Soon